

# LEAD-FREE COPPER ALLOY CHECK

## CLASS 125

Y-Pattern Swing Type • PTFE Disc • Screwed Cap • Integral Seat

\*NSF/ANSI 61-G & NSF/ANSI 372

### CODE #822T (AKYRNT) THREADED (½"-2")

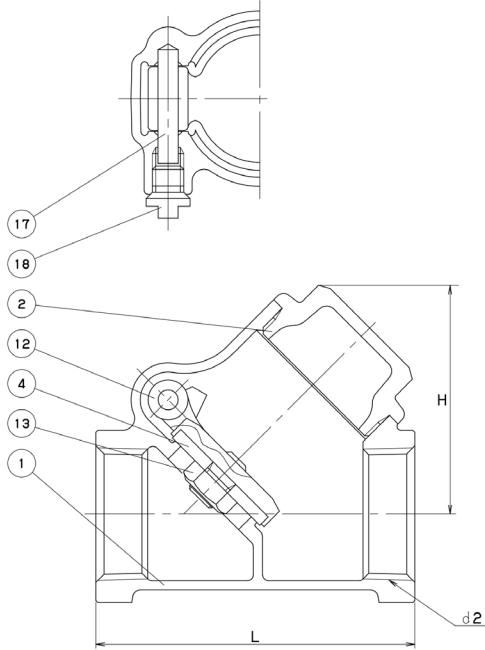

### CODE #823T (CYRNT) SOLDER (½"-2")

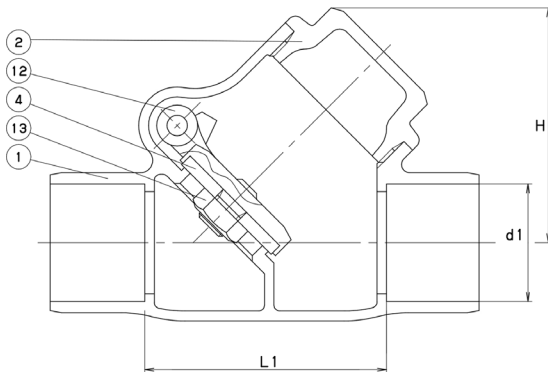

### STANDARDS

END TO END	KITZ STD.
THREADED ENDS	ASME B1.20.1
SOLDER ENDS	ASME B16.18
DESIGN†	MSS SP-80, Type 4

### PRESSURE - TEMPERATURE

200 PSI - NON-SHOCK COLD WORKING PRESSURE (CWP)  
180 PSI @ 212°F

### MATERIAL LIST

NO.	NAME OF PART	SPECIFICATION
1	BODY	LF BRONZE (C89530)
2	CAP	LF FORGED BRASS (C46750)
4	DISC	PTFE
12	DISC HOLDER	LF CAST BRONZE (C89530)
13	DISC NUT (½" - 1")	STAINLESS STEEL (304)
	(1¼" - 2")	LF FORGED BRASS (C46750)
17	HINGE PIN	COPPER (C11000)
18	PLUG	LF BRASS ROD (C46750)

† Lead Free materials are not listed under MSS SP-80, Table 2.

### DIMENSIONS & WEIGHTS

SIZE d2		H	L	L1	d1		Wt. Lb/Kg	Crtn Qty
					Max	Min		
in	½	1.57	2.20	1.64	0.631	0.627	0.33	96
mm		39.9	55.9	41.7	16.0	15.9	0.15	
in	¾	1.93	2.76	1.89	0.881	0.877	0.90	60
mm		49.0	70.1	48.0	22.4	22.3	0.41	
in	1	2.28	3.15	2.31	1.132	1.128	1.00	48
mm		57.9	80.0	58.7	28.8	28.7	0.45	
in	1¼	2.80	3.74	2.82	1.382	1.378	2.04	24
mm		71.1	95.0	71.6	35.1	35.0	0.93	
in	1½	3.15	4.33	3.21	1.633	1.628	2.61	18
mm		80.0	110.0	81.5	41.5	41.4	1.18	
in	2	3.74	5.04	4.01	2.133	2.128	5.92	12
mm		95.0	128.0	101.9	54.2	54.1	2.68	



Certified to NSF/ANSI 61-G

\*Product complies with NSF/ANSI Standard 61 Annex G, NSF/ANSI Standard 372 and conforms with lead content requirements for "lead free" plumbing as defined by California, Vermont, Maryland, and Louisiana state laws and the U.S. Safe Drinking Water Act that went into effect January 2014.