

# BUTTERFLY VALVES - 250 PSI

Ductile Iron Body • Extended Neck • ISO Mounting Pad  
 Bi-Directional • Square Drive • Molded Seat Liner • Gear Operator • Lug & Wafer Design  
**SIZE 10" ~ 12"**

DESIGN STANDARDS: MSS SP-67, MSS SP-25 & API-609 END CONNECTION: ANSI CLS. 125/150 FLANGES WALL THICKNESS: KITZ STD

DJ SERIES BUTTERFLY VALVES - 250 PSI - GEAR OPERATOR

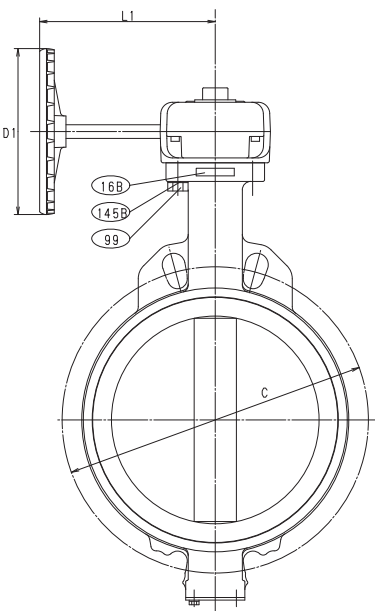
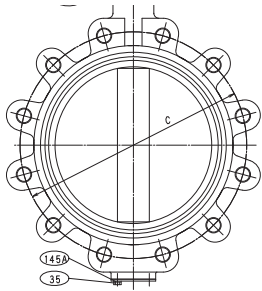
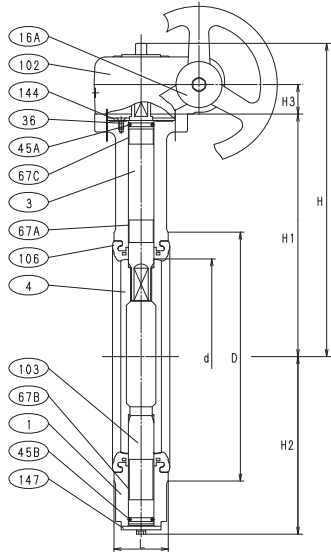

MATERIAL LIST		
NO.	NAME OF PART	SPECIFICATION
1	BODY	DUCTILE IRON (A536)
3	STEM	STAINLESS STEEL (A276, Type 410; AISI, Type 329)
4	DISC (1)	DUCTILE IRON, AL. BRONZE, AND 316 SS
16A/B	NAME PLATE	ALUMINUM
35	END PLATE BOLTS	CARBON STEEL
36	GLAND PLATE BOLT	STAINLESS STEEL
45A/B	O-RING	NBR/EPDM
60	KEY (1/2")	CARBON STEEL
67A/B/C	STEM BEARING	METAL BACKED PTFE
99	SET BOLTS	CARBON STEEL
102	GEAR UNIT	
103	BOTTOM STEM	STAINLESS STEEL (A276, Type 410; AISI, Type 329)
106	SEAT RUBBER (2)	NBR/EPDM
144	GLAND PLATE	CARBON STEEL
145A/B	SPRING WASHER	CARBON STEEL
147	END PLATE	CARBON STEEL

(1) Line scribed on top of the stem indicates the disc direction.  
 (2) Vulcanized to the Body

DIMENSIONS										
SIZE	d	D	C	H	H1	H2	L	D1	Wafer Lug	
									Lbs. Kgs.	Lbs. Kgs.
in. 10	9.72	12.28	14.25	15	11.97	8.62	2.69	9.84	55.6	79.6
mm 250	246	312	362	381	304	219	68.3	170	25.0	36.0
in. 12	11.65	14.33	17.00	15.98	12.95	9.61	3.06	9.84	70.6	106.6
mm 300	295	364	432	406	329	244	77.7	170	32.0	48.0

For gear operator details, refer to page 24.

**NOTE:**

KITZ lug style butterfly valves are rated for bi-directional dead end service to full working pressure of the valve with the downstream flange removed. In dead end service exceeding 96 hours, a downstream flange is recommended.



**Code # 5113 (B/E)G**  
 Disc: Ductile Iron (A536 + ENP)

**Code # 5123 (B/E)G**  
 Disc: Aluminum Bronze (C95400)

**Code # 5133 (B/E)G**  
 Disc: 316 SS (A351 Gr. CF8M)

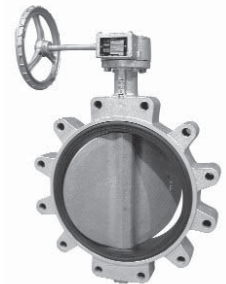

**Code # 6113 (B/E)G**  
 Disc: Ductile Iron (A536 + ENP)

**Code # 6123 (B/E)G**  
 Disc: Aluminum Bronze (C95400)

**Code # 6133 (B/E)G**  
 Disc: 316 SS (A351 Gr. CF8M)